



Strong As An Ox™

BX1625 Installation Instructions **1998-04 Chevrolet S10 Pickup 2WD** **1998-03 GMC S15 GMC Sonoma 2WD**

Utilization of Blue Ox baseplates with any tow bar not approved by Automatic Equipment Mfg. Company invalidates the limited warranty.

Installation of this baseplate requires drilling 17/32" holes in the vehicle's frame.

1. Read the General Instruction Sheet included with this baseplate.
2. The baseplate bolts to the bottom of the frame behind the bumper using bolts supplied with the baseplate. Use of Loctite to secure the bolts is highly recommended. The vibrations and stresses of towing can cause bolts to loosen even with lock washers in the assembly.
3. There are two frame rails behind the bumper that run the length of the pickup. The front 10" of the frame angles up. At the point where the frame levels out there is a hole in the bottom of the frame. This hole will match up to the rear hole in each arm of the baseplate. In the inside wall of the frame rail there are several oblong openings. These will allow you to insert a nut into the frame and hold it in position with the attached wire.
4. Insert a nut into the frame on each side and position it over the holes located in Step 3. With an assistant, hold the baseplate in position and start two 1/2 x 1 1/2 bolts and lock washers into the nut in the frame. Apply Loctite, but do not tighten completely. The attachment tabs for the tow bar should protrude from under the bumper plastic and will angle up slightly. The up angle is intentional and normal.
5. On the driver's side the vertical bracket should align with a hole already in the frame. Adjust the location of the baseplate to align the hole. Tighten the rear bolts completely.
6. Drill out the hole in the frame on the driver's side to 17/32". "Fish" another nut into the frame and install a 1/2 x 1 1/2 bolt, lock washer, and flat washer. Apply Loctite and tighten completely.
7. Using the baseplate as a template, drill the remaining two holes and complete bolting the baseplate to the frame.
8. The dimensional variations between otherwise identical cars can be considerable. While the location and size of the holes in the baseplate were designed to allow for easy installation, it may be necessary to file a hole slightly to allow a bolt to clear.
9. Install the tow bar and safety cables according to the instructions included in their packages.
10. Do not substitute other devices if the tow bar pin and clip are lost.

11. DEALER OR INSTALLER: BE CERTAIN THE USER RECEIVES THE INSTRUCTION SHEET.

Tools Required

Drill
3/4" Wrench

17/32" Bit
Loctite Red

Parts List

Ref. No.	Qty.	Part No.	Description
1	1	61-5166	Weldment, Baseplate, BX1625
2	5	61-4029	Weldment, 1/2" Nut Wire
3	5	201-0051	1/2-13 x 1 1/2" Hex Bolt, Grade 5
4	1	203-0005	1/2" Flat Washer
5	5	203-0012	1/2" Lock Washer
	2	226-0046	Baseplate Safety Cable, 36" CL III (Not Shown)
	4	229-0359	Quicklink, 3/8, ZP (Not Shown)

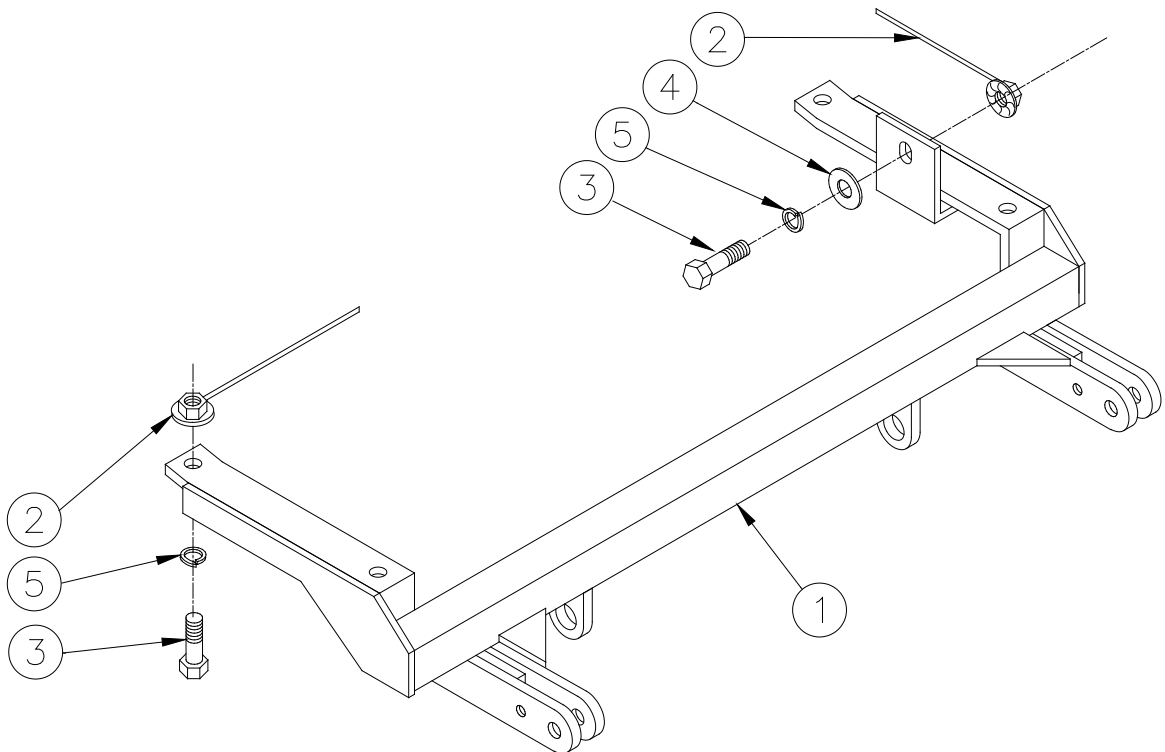

General Information

1. Ensure that your product(s) are registered online at www.blueox.com. It is crucial to register your product(s) so that you may be alerted of product offerings, updates, upgrades, maintenance and safety bulletins, and/or recalls.
2. **It is the owner's responsibility to inspect all towing equipment for cracked welds, missing or worn parts and loose bolts before each towing trip.** Be sure to use Loctite® Red on all bolts and tighten to the recommended specifications.
3. **It is the owner's responsibility to hook up all towing equipment per manufacturer's instructions/recommendations.**
4. Remove the attachment tabs when not in use (if applicable).

Notice To Baseplate Installer

1. It is YOUR responsibility to watch for:

- Oil cooler and air conditioner lines
- Electrical wires and hoses
- Missing parts or attaching points on the frame

** If the baseplate is improperly installed and is against a wire or hose, it could cause fluid leaks or electrical shorts some time after the actual baseplate installation.

Permanent Baseplate Safety Cable Installation

Permanent baseplate safety cables are strongly recommended when towing a vehicle with a tow bar. The principle function of the permanent baseplate safety cables is to prevent the towed vehicle from breaking loose in the event the connection between the frame of the towed vehicle and the baseplate fails or becomes disconnected. The cables must be connected from the baseplate to the frame rail or cross member of the vehicle's frame. The illustrations below show the possible arrangements recommended by Blue Ox®. Each permanent baseplate safety cable must have an adequate weight rating for the towing system. The weight rating of the two (2) cables together will not qualify.

Do not mount the permanent baseplate safety cables against wires, hoses or brake lines.

These permanent baseplate safety cables should remain installed as long as the baseplate is installed on the vehicle. Permanent baseplate safety cables are to be used in conjunction with, and NOT a replacement for legally required safety cables attaching the towed vehicle to the towing vehicle.

Option #1

(Baseplates with Convenience Link Tabs)

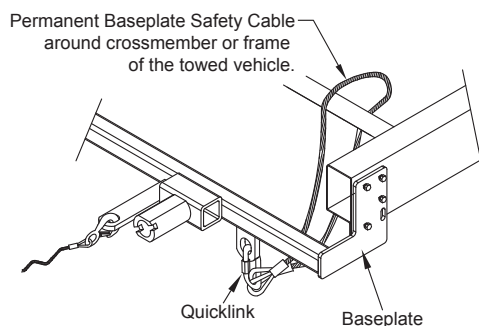

Option #2

(Baseplates with out Convenience Link Tabs)

